

# TUNNEL SUBWAY GUIDANCE SERIES WIRED POWER LED ROAD MARKERS

BESIDE THE SHELLS WE SUPPLYING NOW,  
CUSTOMIED SHELL AVAILABLE FOR ALUMINUM TYPE

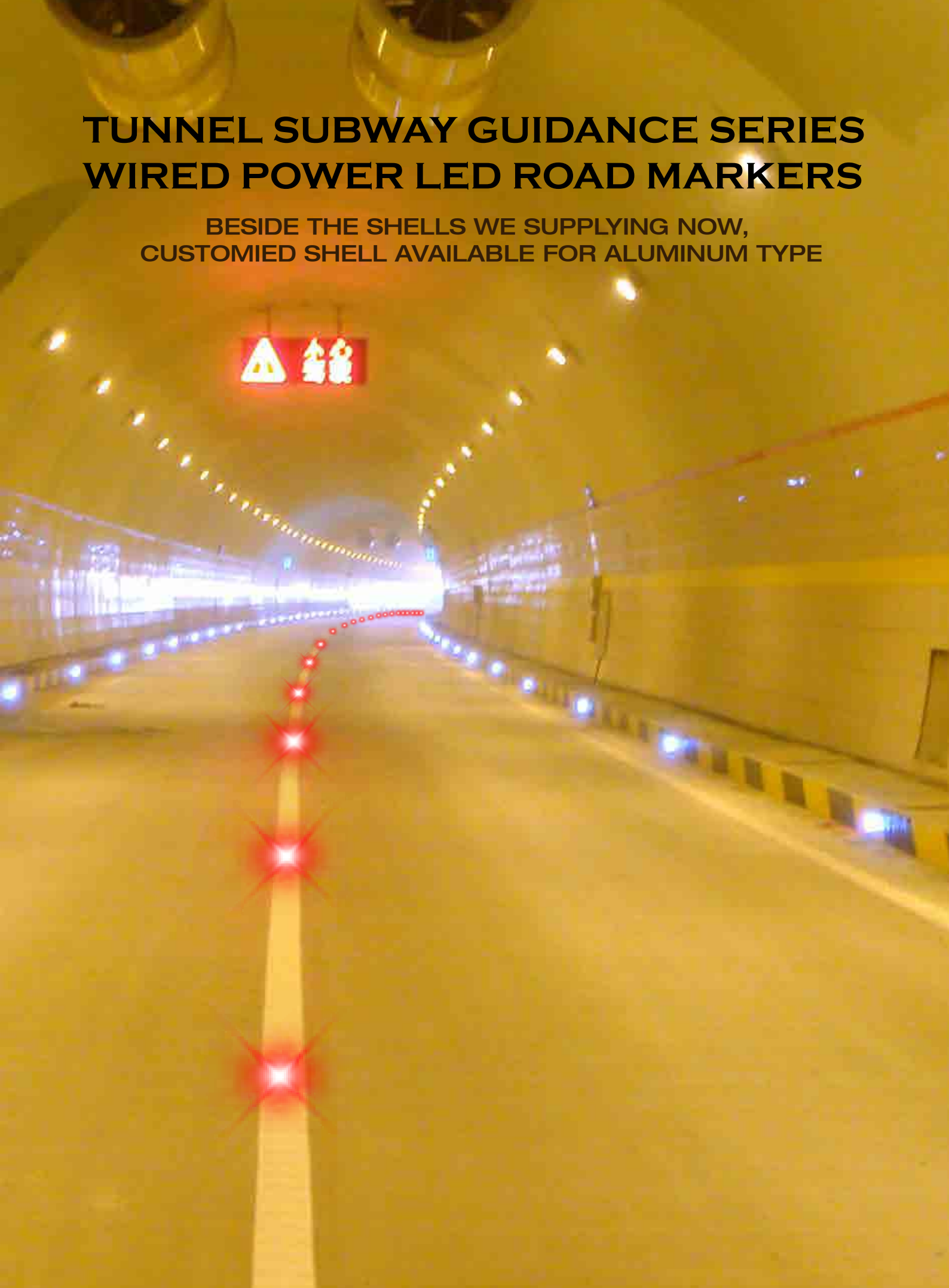

# Item No: WPRS112

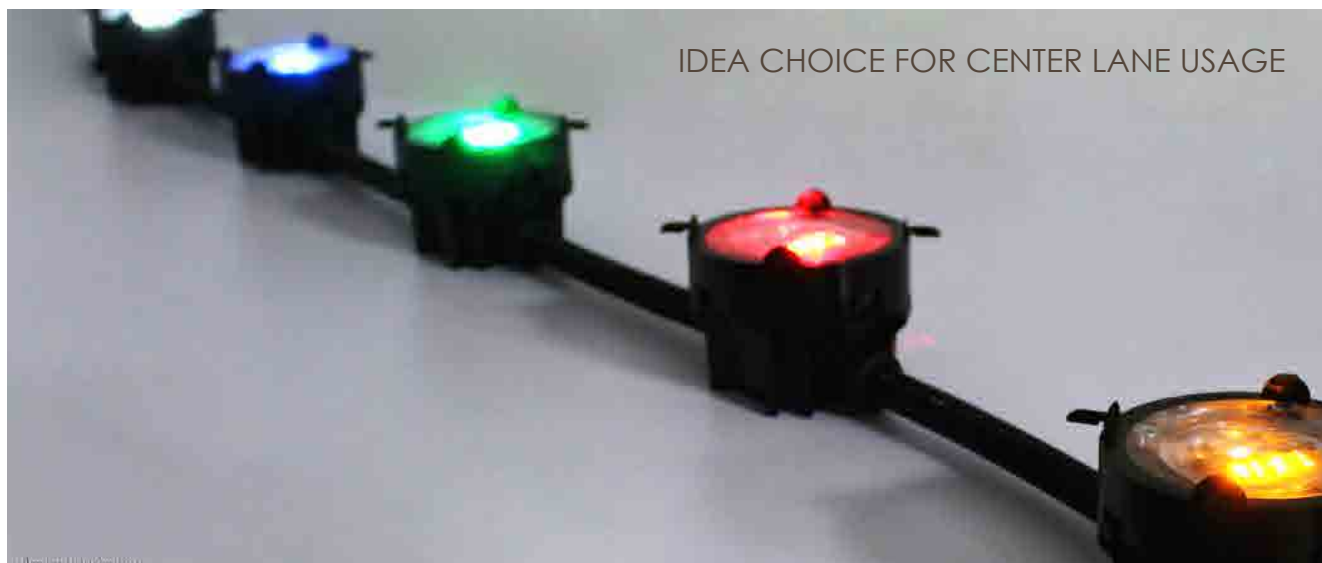

## Applications :



Motorway



Dynamiclane



Crosswalk



Traffic Circle



Cycleway



Parking Lot



Park



Garden



Railway



Airport



Architecture



## Key Feature

1. Visibility over 1000 meters
2. Easy to install and maintain
3. Definitely economical design: Lower unit cost and lower installation cost (smaller installation hole: dia.90mm)

## Specification

1. Size: Dia.89mm (3.5 inch) X 65mm
2. Shell: Special PC
3. Shell Color: Black or customized
4. Compression resistance: over 20 tons
5. Water-proof: IP68
6. LED: 6 pcs supper bright LEDs
7. Frequency: steady or flashing according to the controller
8. Led color: white, red, yellow, green, blue
9. Working temperature: -40 degree - +70 degree
10. Viewing distance: >1000 meters
11. Power consume: <0.1W / pc
12. Weight: 0.350 KGS
13. Packing: 1 pc/box, 6pcs/carton, Carton size: 23\*24\*15cm

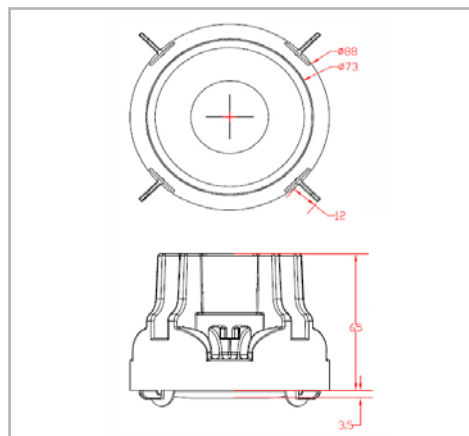

# Item No: WPRS212



### Applications :



### Key Feature

- 1. High quality ultra-bright LEDs 8 pcs X 2 sides
- 2. Perfect water proof: IP 68
- 3. Easy to install with 2 screws onto the wall, easy to repair and replace

### Specification

- 1. Size: Dia.100mm, Height: 26mm
- 2. Shell Color: White or Black
- 3. Working type: Steady or flashing
- 4. Power supply: 12V-24V DC
- 5. Power consume: <1W
- 6. Material: PC
- 7. Ultra bright  $\Phi 5\text{mm}$  LEDs,8pcs X 2 sides, use life over 100 000 hours
- 8. LED Color: White, yellow, red, blue, green
- 9. Long use life over 5 years
- 10. Water proof IP68
- 11. Weight: 280g/pc
- 12. Package: 2pcs in one box  
12pcs/carton, carton size: 22\*22\*12.5cm

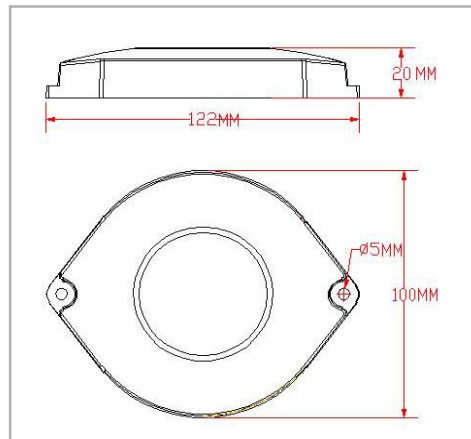

# Item No: WPRS214



### Applications :



### Key Feature

- 1. One direction or 2 directions optional
- 2. Each side 6 pcs LEDs
- 3. Perfect water proof - IP 68

### Specification

- 1. Size: 100mmX 100mmX 20mm
- 2. Shell Color: White or customized
- 3. Working type: Steady or flashing
- 4. Power supply: 12V-24V DC
- 5. Power consume: <1W
- 6. Material: PC
- 7. Ultra bright Φ5mm LEDs, 6pcs X 2 sides, use life over 100 000 hours
- 8. LED Color: White, yellow, red, blue, green
- 9. Long use life over 5 years
- 10. Water proof IP68
- 11. Weight: 280g/pc
- 12. Package: 2pcs in one box  
12pcs/carton, carton size: 22\*22\*12.5cm

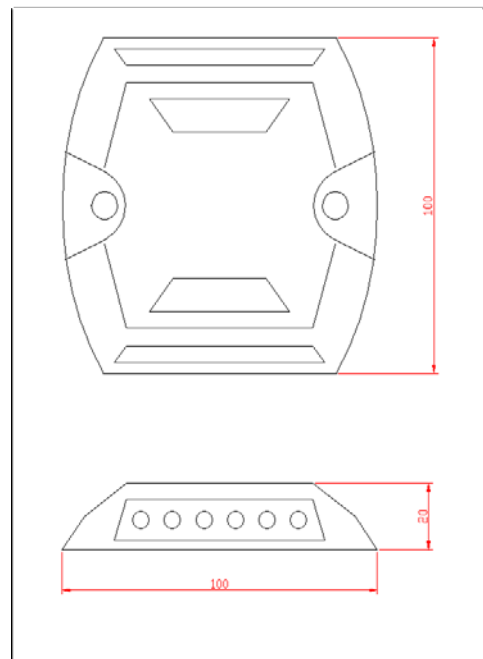



# Item No: WPRS222



### Applications :



### Key Feature

1. Visibility over 800 meters.
2. Lower unit cost and lower installation cost
3. Anti-pressure: 20 tons

### Specification

1. Size: 110mm X 100mm X 20mm
2. Shell material : Aluminum
3. Compression resistance: over 20 tons
4. Water-proof: IP68
5. LED: 6 pcs Supper bright LEDs each side
6. Frequency: steady or flashing according to the controller
7. Led color: white, red, yellow, green, blue
8. Working temperature: -40 degree - +70 degree
9. Viewing distance: >800 meters
10. Power consume: <0.2W / pc
11. Power input: 12~24V DC

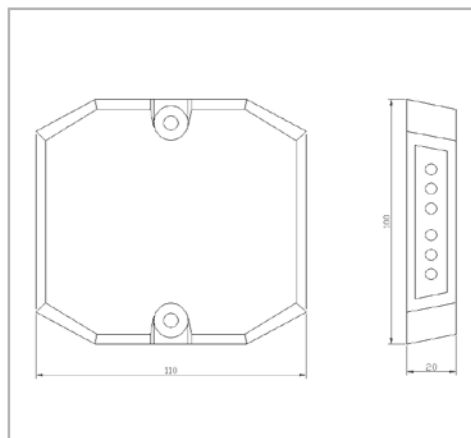

Item No: WPRS215



**Applications :**

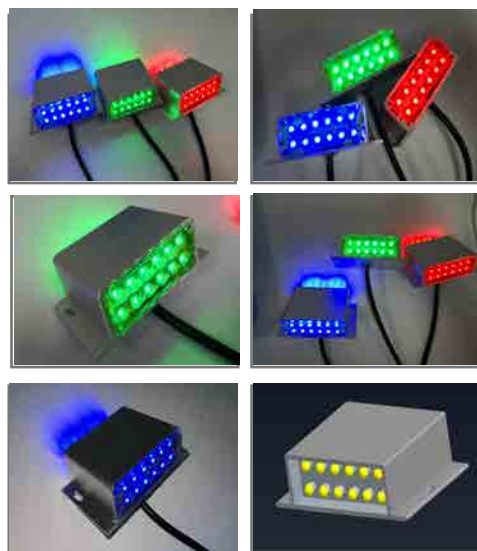

**Key Feature**

- 1. Visibility over 800 meters.
- 2. Lower unit cost and lower installation cost
- 3. Anti-pressure: 20 tons

**Specification**

- 1. Size: 82mm X 55mm X 23mm
- 2. Shell material : Aluminum
- 3. Compression resistance: over 20 tons
- 4. Water-proof: IP68
- 5. LED: 12 pcs Supper bright LEDs each side
- 6. Frequency: steady or flashing according to the controller
- 7. Led color: white, red, yellow, green, blue
- 8. Working temperature: -40 degree - +70 degree
- 9. Viewing distance: >800 meters
- 10. Power consume: <1W / pc
- 11. Power input: 12~24V DC

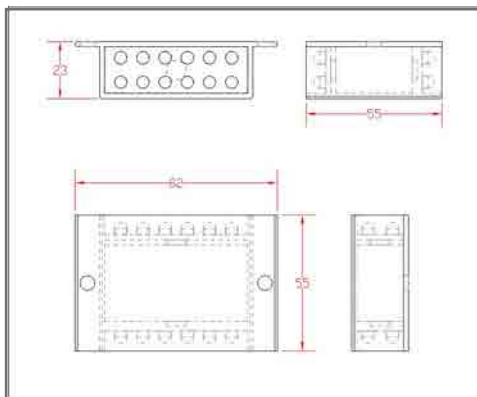

## Other Products in Tunnel Safety Series

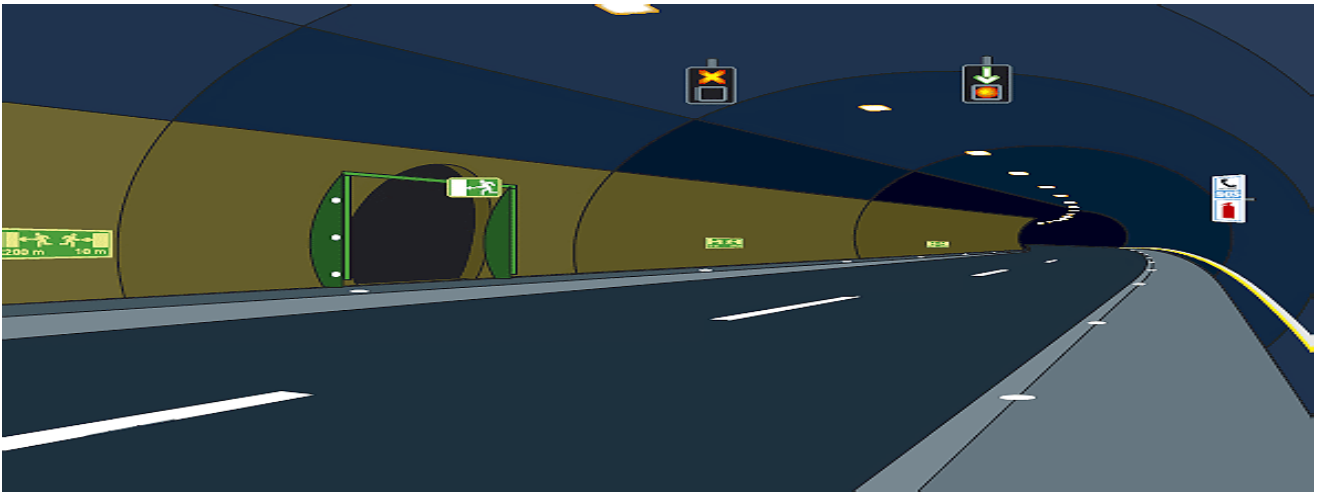

Item No: B031 CONTROLLERS FOR MARKERS

Input Power: 220V AC  
 Output: 12-24V DC  
 Functions:  
 Continuely On  
 Flashing 2 HZ  
 5 Push Sequentially Flashing



Controller Case  
 Customizable for different sizes



Item No: B032  
 Side Emergency Guidance Markers

Input: 12-24V DC  
 Power: 1W  
 LED Quantity: 15 pcs  
 LED Color: Green, White, Yellow, Red, Blue



Item No.: B033 Escape LED Illuminated Signals



Item No.: B034  
 Changeable Tunnel Speed Display

Item No.: B035  
 LED Lane Directional Display



