

Drawings:

Installation Instructions:

Easily Installed with 4 Screws
Post installation adapter included
Easily Installation to the Wall



Other Related Items:

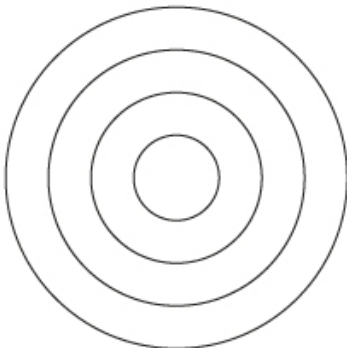

Size we supply:
Dia.200mm, Dia.100mm
Dia.80mm, Dia.50mm

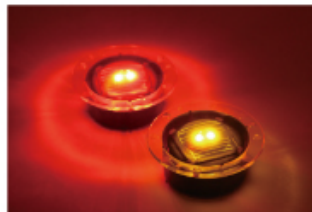

Dia.50MM
1 LED on the Top
360 degree Visible
Embedded Design
1 / 2 / 3 LEDs available

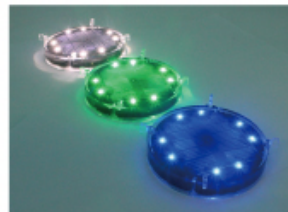

Dia.100MM
8 LEDs on the Top
360 degree Visible
Embedded Design



Dia.200MM
20 LEDs on the Top
360 degree Visible
Embedded Design

Solar Dock Deck Step Lights



SRS0318



SRS0301



SRS0403



TD014



SRS0401

Solar Underground Lights



Item No: SAL01501



Applications :



Architectural



Park



Garden

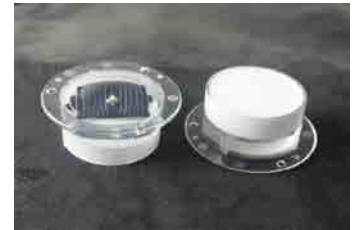

Key Feature

1. Special reflector design: 360 Degree illuminated
2. Perfect water proof: IP 68
3. Well fit the road surface, especially for cycle ways, only 5mm over the road surface

Specification

1. Size: Dia.50mm (Ring: Dia.65mm), Height: 26mm
2. Light source: 1 pcs Dia.5MM LED
3. Working type: Steady or flashing
4. Full charge time: 8 hours
5. Working type after full charge: over 20 hours
6. Start working: from 500 Lux
7. Material: PC
8. Solar Cell type: Mono crystalline 2V, 40Mah.
9. Storage battery: 1.2V 300Mah
Work temperature: -30 C ~ +75 C
10. Ultra bright LEDs, use life over 100 000 hours
11. Color: White, yellow, red, blue, green
12. Long life time
13. Water proof IP68
14. Weight: 80g/pc
15. Package: 1 pcs in one box (105mm X 105mm X 20mm)
72 pcs/Cartron, Size: 250mm X 250mm X 350mm

Drawings

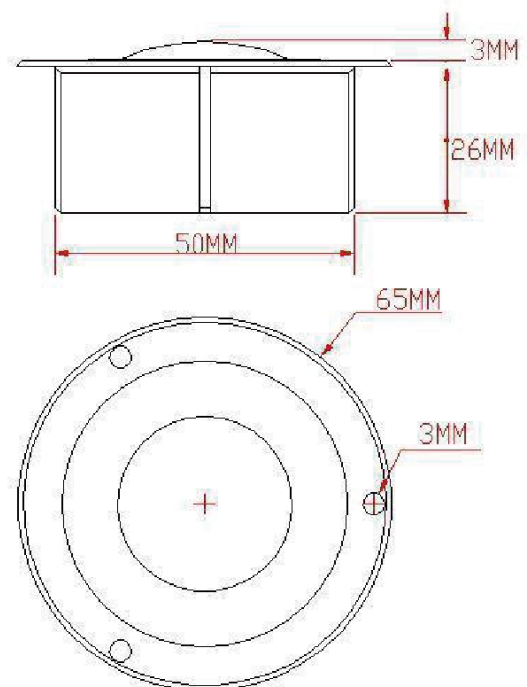

SAL01501 – Top 1 LED

Item No: SAL0180B28



Applications :



Architectural



Park



Garden



Key Feature

1. High quality anti-heating Ni-MH battery, long use life over 3 years
2. Perfect water proof: IP 68
3. Well fit the road surface, especially for cycle ways, only 5mm over the road surface
4. Easy installation ring design

Specification

1. Size: Dia.80mm (Ring: Dia.100mm), Height: 26mm
2. Working type: Steady or flashing
3. Full charge time: 8 hours
4. Working type after full charge: over 15 hours
5. Start working: from 500 Lux
6. Material: PC
7. Solar Cell type: Mono crystalline 2V, 160Mah.
8. Storage battery: 1.2V 1200Mah
Work temperature: -35°C ~ +75°C
9. 8 pcs Ultra bright Φ5mm LEDs, use life over 100 000 hours
10. Color: White, yellow, red, blue, green
11. Weight: 180g/pc
12. Package: 2pcs in one box 12pcs/Carton box,
Size: 33cm X 34cm X 15cm

Drawings

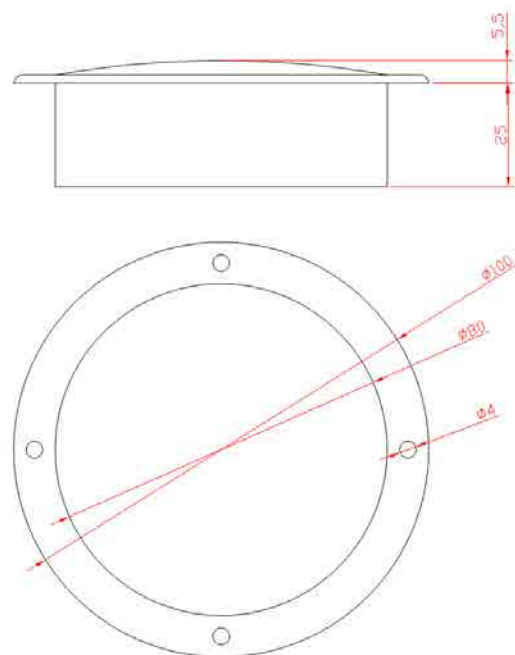

Item No: SAL01 100V8(VERTICAL Design)



Applications :



Architectural



Park



Garden

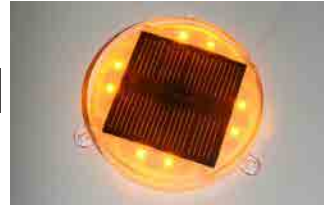
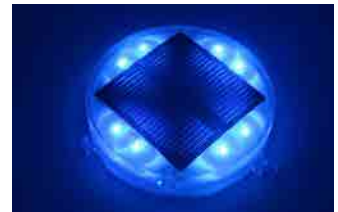

Key Feature

1. High quality Anti-heating Ni-MH battery, long use life over 5 years
2. Perfect water proof: IP68
3. Easy Vertical installation onto the wall

Drawings

Specification

1. Size: Dia.100mm, Height: 20mm
2. Weight: 280g/pc
3. Working type: Steady or flashing
4. Full charge time: 8 hours
5. Working type after full charge: over 20 hours
6. Brightness: optional
7. Start working: from 500 Lux
8. Material: PC
9. Solar Cell type: Mono crystalline 2V, 240Mah.
10. Storage battery: 1.2V 1200Mah, Ni-MH battery
11. Work temperature: -35 C ~ +75 C
12. 8 pcs Ultra bright LEDs, use life over 100 000 hours
13. Color: White, yellow, red, blue, green
14. Package: 3 pcs in one box (105mm X 105mm X 20mm)
18 pcs/Carton, Size: 230mm X 240mm X 150mm

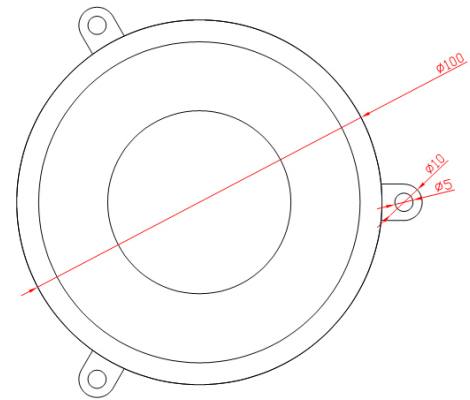

Horizontal Design Available



SAL0130 Solar Pointolite Light



Applications :



Architectural



Park



Garden

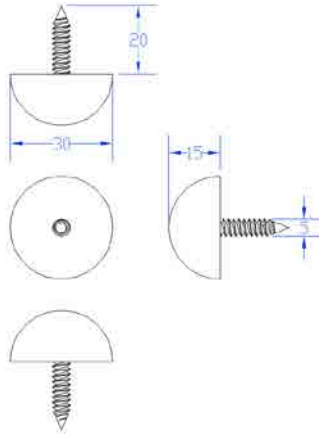

Key Feature

1. Easy Installation
2. Perfect water proof: IP68
3. No maintenance cost

Specification

1. Size: Dia.30mm, Height: 25mm
2. Weight: 50g/pc
3. Working type: Steady or flashing
4. Full charge time: 8 hours
5. Working type after full charge: over 20 hours
6. 1 pc Ultra bright LEDs
7. Start working: from 500 Lux
8. Material: PC
9. Solar Cell type: Mono crystalline 2V, 35Mah.
10. Storage battery: 1.2V 300Mah, Ni-MH battery
11. Work temperature: -15 °C ~ +65 °C
12. Color: White, yellow, red, blue, green
13. Package: 4 pcs in one box (105mm X 105mm X 20mm)

SAL0980 Solar Pointolite / Pixel Light

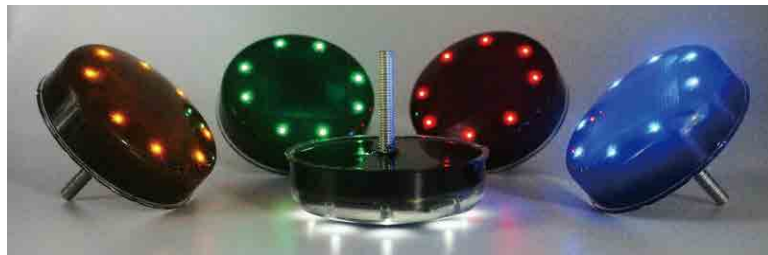

Applications :



Architectural



Park



Garden

Key Feature

1. Easy Installation
2. Perfect water proof: IP68
3. No maintenance cost

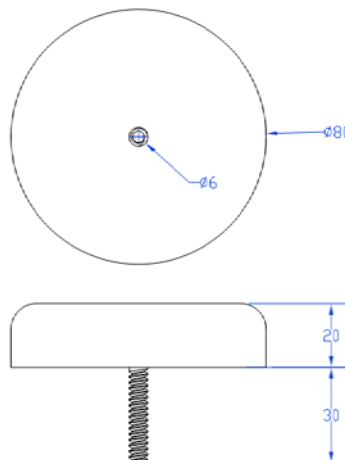

Specification

1. Size: Dia.80mm, Height: 25mm
2. Weight: 80g/pc
3. Working type: Steady or flashing
4. Full charge time: 8 hours
5. Working type after full charge: over 20 hours
6. 1 pc Ultra bright LEDs
7. Start working: from 500 Lux
8. Material: PC
9. Solar Cell type: Mono crystalline 2V, 120Mah.
10. Storage battery: 1.2V 600Mah, Ni-MH battery
11. Work temperature: -15 °C ~ +65 °C
12. Color: White, yellow, red, blue, green
13. Package: 4 pcs in one box (105mm X 105mm X 20mm)

SAL02XX – Solar Bricks

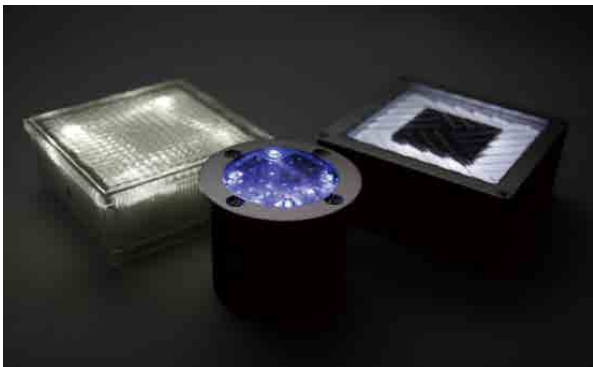

Applications :



Architectural



Park



Garden

Key Feature

1. Easy Installation
2. Perfect water proof: IP68
3. No maintenance cost

Specification

1. Size: Different sizes optional
2. Customized size available when order quantity over
3. Working type: Steady or flashing optional
4. Full charge time: 8 hours
5. Working type after full charge: over 10 hours
6. Light source : Ultra bright LEDs
7. Start working: from 500 Lux
8. Material: Glass
9. Solar Cell type: Mono crystalline 2V
10. Storage battery: 1.2V Ni-MH battery
11. Work temperature: -15°C ~ +65°C
12. Color: White, yellow, red, blue, green
13. Package: 1 piece in one box

SAL0270

Size: 70mmX70mmX50mm

SAL02100

Size: 100mm X 100mm X 50mm

SAL02150

Size: 150MM X 150MM

SAL02195100

Size: 195MM X 100MM



SAL02200100

Size:

200mmX100mmX50mm

Material: S304

6 pcs LEDs,

Waterproof: IP68

SAL03X – Solar Underground Lights



Item No.: SAL0380

Solar inground light
 Size: Dia.80*75MM
 Installation siz: Dia.70MM
 4 PCS LEDs



Item No.: SAL0389,

Dia.89MM X 30MM / 3-4 LEDs around

Item No.: SAL03111

Dia.111MM X 30MM / 8-12 pcs LEDs around

Item No.: SAL03136

Dia.136MM X 30MM / 8-12 pcs LEDs around



Key Feature

1. Easy Installation
2. Perfect water proof: IP68
3. No maintenance cost



Item No.: SAL03250

Size: Dia.250*55MM
 8-20 pcs LEDs around

Specification

Working type: Steady or flashing optional
 Full charge time: 8 hours
 Working type after full charge: over 10 hours
 Light source : Ultra bright LEDs
 Start working: from 500 Lux
 Material: Aluminum or S304
 Solar Cell type: Mono crystalline 2V
 Storage battery: 1.2V Ni-MH battery
 Work temperature: -15 C ~ +65 C
 Color: White, yellow, red, blue, green
 7 Changing color model available
 Package: 1 piece in one box

For a

Green Safer Home



BENEDRIVE INTERNATIONAL CO., LTD.

Add: FLAT/RM 15B 15/F Cheuk Nang Plaza 250 Hennessy RD, Hong Kong
TEL: +852 9730 4233

SHENZHEN BENEDRIVE TECHNOLOGY CO., LTD.

Factory Add.: C401B, KingDao Science Park, ChuangYe RD, ShiYan Town,
BaoAn Dist., ShenZhen, P.R.China PO:518108
Tel: +86 156 0290 1287 (Wechat)
+86 755 2329 0071 / 0072
E-mail: sales@benedrive.com